

VTE®

MODEL 3HP INSTRUMENTATION SERIES

3-Way Threaded Standard Port Ball Valves



Pinned End Connections

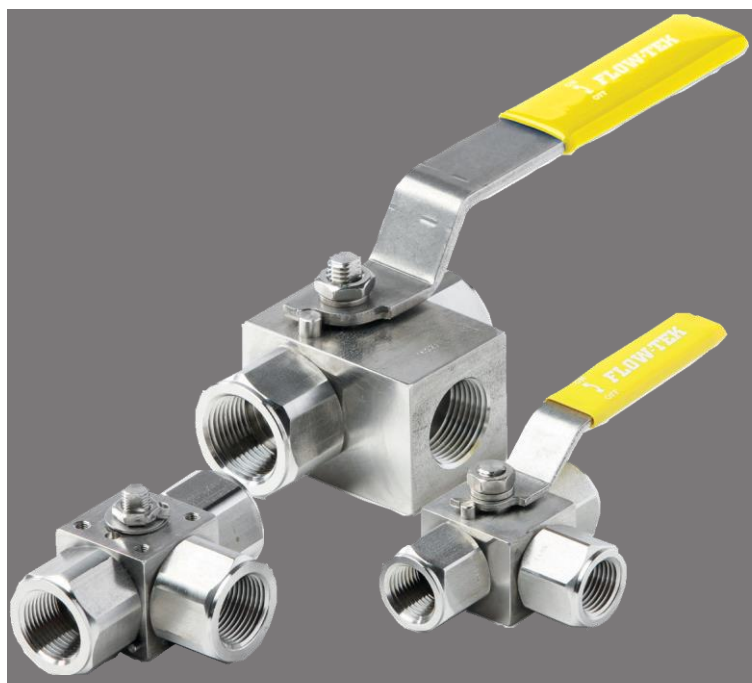

Flow-Tek's Instrumentation Series 3-Way ball valves offer rugged reliability for high pressure and instrumentation applications.

The valves feature three piece bodies designed for flexibility of installation and ease of maintenance. Model 3HP is constructed as standard with 316 stainless steel bodies manufactured to NACE specifications. Other body materials are available such as Duplex

SS, Hastelloy, Monel and Titanium. All bodies are marked with a heat code for full material traceability.

A floating ball design provides a positive, bubble tight shut off with smooth quarter turn operation at low operating torque. Additional advantages of the Instrumentation Series include a choice of lever or pointer handles, travel limit stop pins and replaceable seats and seals.

Locking kits which secure the valve in a desired position are also available. Safety features include an internally loaded blow-out proof stem and end connections that are pinned to prevent inadvertent loosening or disassembly.

Actuator Mounting

Valves with actuator mounting to ISO 5211 specifications and live loading are also available as an option.

Size	Pressure Rating	Temperature Range	End Connections	Body Material
1/4" to 1" 8 to 25 mm	6000 psi	-40°F to +280°F -40°C to +138°C	Standard: NPT Optional: Compression Fittings	Stainless Steel

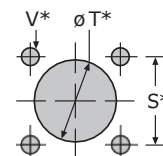
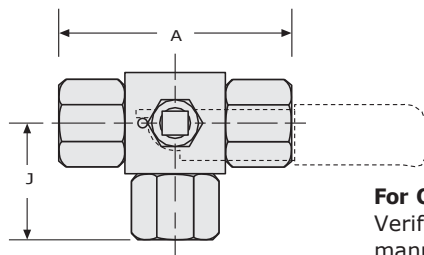
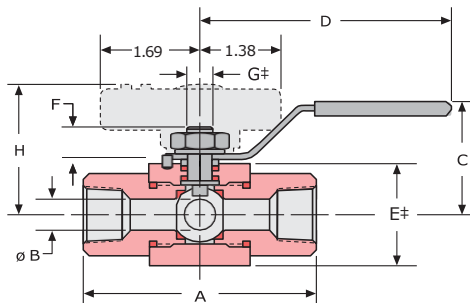

For Optional Panel Mounting:

Verify the mounting dimensions before manufacturing mounting hardware.

Dimensions (inches)

Size in	A	ØB	C	D	E±	F	G±	H	J	S*	ØT*	V*	Torque lb-in	Weight lb
1/4	2.79	0.39	1.77	4.52	1.26	0.63	0.33	1.92	1.40	1.02	1.18	M4x0.236	150	1.1
3/8	3.03	0.39	1.77	4.52	1.26	0.63	0.33	1.92	1.30	1.02	1.18	M4x0.236	150	1.2
1/2	3.34	0.39	1.77	4.52	1.26	0.63	0.33	1.92	1.60	1.02	1.18	M4x0.236	150	1.3
3/4	3.54	0.50	1.96	4.52	1.49	0.59	0.33	2.04	1.80	1.02	1.18	M4x0.236	220	1.8
1	4.37	0.78	2.36	6.49	1.96	1.06	0.49	—	1.50	1.57	1.57	M5x0.315	300	3.8

Dimensions (mm)

Size mm	A	ØB	C	D	E±	F	G±	H	J	S*	ØT*	V*	Torque N m	Weight Kg
8	71	10	45	115	32	16	8.5	49	35.6	26	30	M4x6mm	17	0.5
10	77	10	45	115	32	16	8.5	49	33	26	30	M4x6mm	17	0.5
15	85	10	45	115	32	16	8.5	49	40.6	26	30	M4x6mm	17	0.6
20	90	12.7	50	115	38	15	8.5	52	45.7	26	30	M4x6mm	25	0.8
25	111	20	60	165	50	27	12.5	—	38	40	40	M5x8mm	34	1.7

Ø Indicates round dimensions.

± Indicates square dimensions.

*Option for actuator ready version to be specified when ordering.

A 2-Way version of the Model 3HP valve is also available. Please see Flow-Tek brochure HP/HX.

Flow Pattern

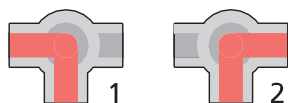

Standard Side Entry
Flow Diversion

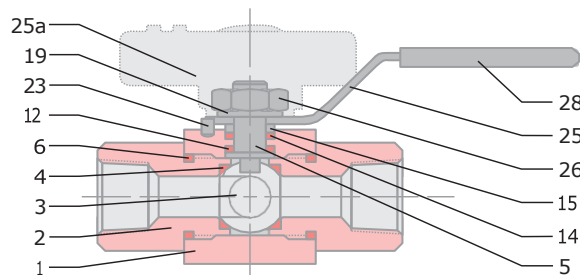

Cv Model 3H

Size - ins	1/4	3/8	1/2	3/4	1
Size - mm	8	10	15	20	25
L-Port	5.3	5.3	5.3	8.6	21

Pressure/Temperature

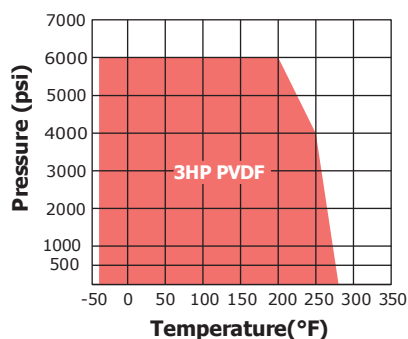

COMPONENTS & MATERIALS

Item	Name	Material	Qty.
1	Body	Stainless Steel 316	1
2	End Connector	Stainless Steel 316	2
3	Ball	Stainless Steel 316	1
4	Seat*	PVDF	2
5	Stem	Stainless Steel 316	1
6	Body Seal*	RPTFE	2
12	Thrust Washer*	RPTFE	1
14	Stem Packing*	RPTFE	1
15	Packing Gland	Stainless Steel	1
19	Lock Washer	Stainless Steel	2
23	Stop Pin	Stainless Steel	1
25	Lever Handle	Stainless Steel	1
25a	Pointer Handle	Mazak 3	1
26	Lock Nut	Stainless Steel	1
28	Handle Sleeve	Vinyl	1

*Parts included in the repair kits.

Other body and seat materials are also available.

Please contact your Flow-Tek representative for options.

VAL TECHNOLOGY & ENGINEERING SDN. BHD.

No. 1, Lorong Teras Jaya 3, Taman Perindustrian Teras Jaya,
13400 Butterworth, Penang, Malaysia.

Tel: +604-333 4119 (Hunting) Fax: +604-333 4120

Email: sales@valtech.com.my

URL: www.valtech.com.my